

planika

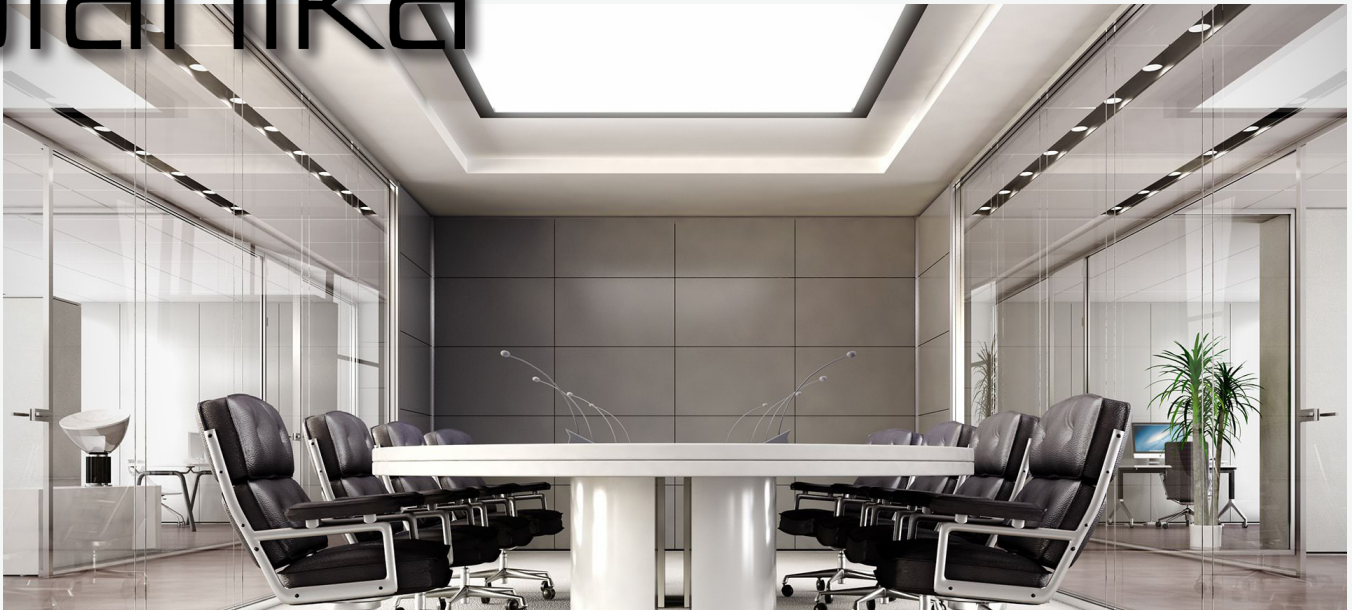

Product Sheet

PLANIKA demising office wall systems are fully demountable offering versatility and flexibility of design in any space without the long-term commitment of conventional drywall construction. Its steel structure is robust and its modularity makes it easy to interchange panels and add furnishings in no time. Electrical and plumbing ready, safe and easy to clean, PLANIKA is the perfect solution for all settings.

Structure

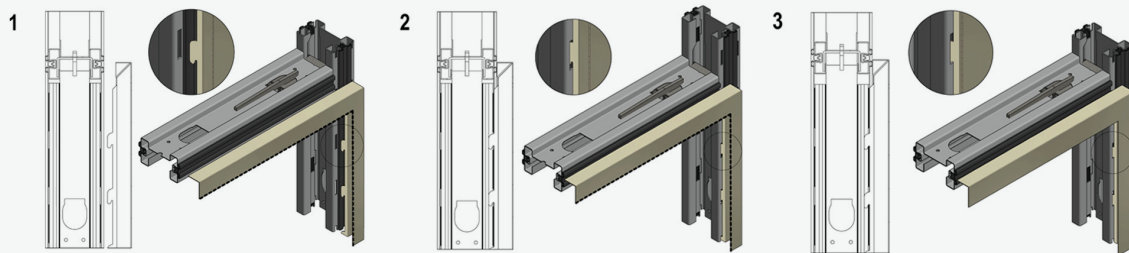



Glazing and Panels:

Panels or "Skins"

- Steel skin: steel sheet wrapped to gypsum board
- Wood skin: low pressure laminate applied to engineered hardwood board
- Custom finishes such as fabric or felt available

Glazing:

- Single and double glazing
- Thickness: 1/2" and 3/8"
- Tempered, laminated, low iron (extra clear), and specialty glass

Profile:

Panel system built on site
 Dimensions: W4"
 Steel structure
 Interchangeable panels with hooks
 Integrates with conventional building construction
 Integrates with MIMO, FINO, and QUADRO office front systems

Doors:

Accommodates all Muraflex doors
 Standard door hardware

- Lever or ladder pull
- Locking or non-locking
- Drop seal available on framed and wood doors
- Hold open available on all swing doors

Maximum door height: 10'

Tolerance:

Tolerance at the top or bottom: 2-3/8"

Junctions:

Wall to wall, corner (L), variable angles, and T condition

Ceiling Condition:

Can be installed on a bulk ceiling, acoustical tiles (ACT), or as a free-standing system
 No maximum height

Acoustical properties:

Tested STC assembly score ranges (depending on options): 42 - 55

Integrated electrical components:

High and low voltage wiring
 Integrated electrical components including room scheduler, card reader, and electrical strike available
 Panic hardware available

Lead times:

8-10 weeks on standard system
 10-12 weeks on custom system



Sustainability

At Muraflex, we are dedicated to diminishing our impact on the environment. We are also committed to continually improving our procedures in terms of product development, supply, packaging and distribution in an effort to minimize our environmental footprint.



Declare.



The Finishes

Wood
White

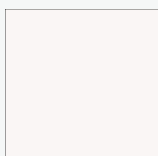

Wood
Sesame



Wood
Maritime Maple

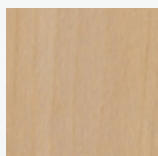

Wood
Ginger root

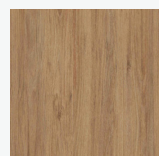

Wood
Carbon

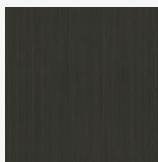

Wood
Dalia

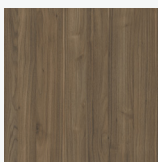

Acier
Polar white

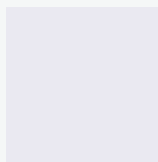

Acier
Silver

